

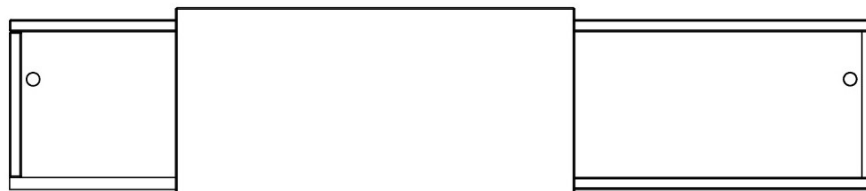

— est. 1964 —

Latitude Installation Instruction



Bathroom Furniture Assembly Instructions

Product Identification

All units can be easily identified from the labels on the packaging. These labels include a description and product batch numbers. In the unlikely event of any missing items, these numbers should be quoted when contacting your supplier.

Please inspect all products carefully before installation.

The guarantee does not cover any subsequent installation costs incurred if faults which would have been evident at the time of delivery are discovered after installation.

Installation Guide and Assembly Manual

It is recommended that this guide should be read before any installation of units begins. Always unpack units carefully and check the contents before discarding the packaging as small items may still be in the packaging. To protect units from scratches only lay them on a clean flat surface.

SANITARYWARE

Basins.

Any cabinet edges around wash basins must be sealed with a waterproof agent or sealer.

Basins should be levelled on a bead of silicon onto the base unit if possible before the final water and waste connections are made.

W/C Units

You will need to make cut-outs for pipes and cistern controls as directed by the Manufacturer's instructions or templates, remembering to seal any raw edges. The cistern will require fixing to the cross rail. (These fixings are not supplied)

Please note: These units are designed for back-to-wall pans as well as suspended "wall hung" pans when used with a suitable suspension frame.

Guidelines for Care and Maintenance

To maintain the appearance and prolong the life of your new bathroom products we recommend the following,

Furniture

Wipe spills up immediately with a clean soft damp cloth as excessive amounts of spillage or condensation can cause deterioration of the

woodwork. We recommend that furniture be cleaned with a soft damp cloth and warm soapy water. Avoid using cleaners or polishes that contain abrasives, solvents, acid or ammonia.

Mirrors

Wipe off excessive moisture or condensation, clean with a soft cloth. Avoid using cleaners that contain abrasives, solvents, acid or ammonia.

Ceramic Sanitaryware

Clean with a soft damp cloth and warm soapy water; rinse with clean water and polish with a soft cloth. Avoid using cleaners that contain

abrasives, solvents, acid or ammonia.

Gel-coated Cast Mineral Washbasins

Gel-cast basins are designed and guaranteed to be used with hot water up to a maximum temperature of 65°C, this temperature must not be exceeded

Clean with a soft damp cloth, water and soap or very mild detergent, rinse and polish with a soft cloth. Avoid using cleaners that contain

abrasives, solvents, acid or ammonia. Do not use caustic soda or bleaches. For a good shine use a fine polish around twice a year and then finish with a wax e.g. car wax. Care instructions are included with the washbasin.

Brassware

Clean with a damp cloth, water and soap, rinse clean and polish with a cloth.

Avoid using cleaners that contain abrasives, solvents, acid or ammonia.

Installation

Note: All cabinets should be fastened to the wall before fixing the basin, after alignment we recommend additional wall fixings are made, then the final installation of the basin can be carried out.

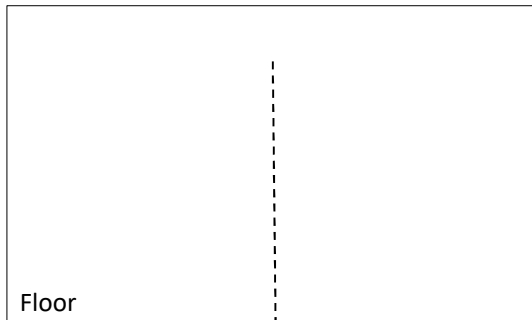

Diagram 1

To begin the installation draw a centre line, taking into account the position of the waste and pipe work. Consult **Diagram 3** for the Min. and Max. dimensions the units can be set apart.

See Diagram 1

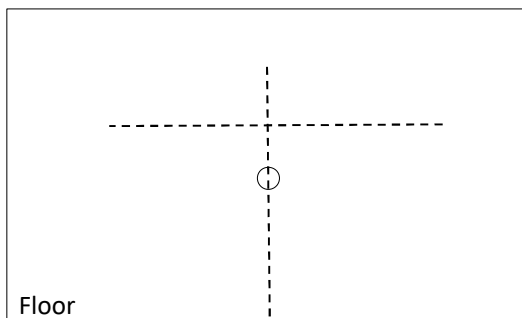

Diagram 2

Mark the desired installation height of the Units.

Note: We recommend an installation height of approx. **800mm**.

See Diagram 2

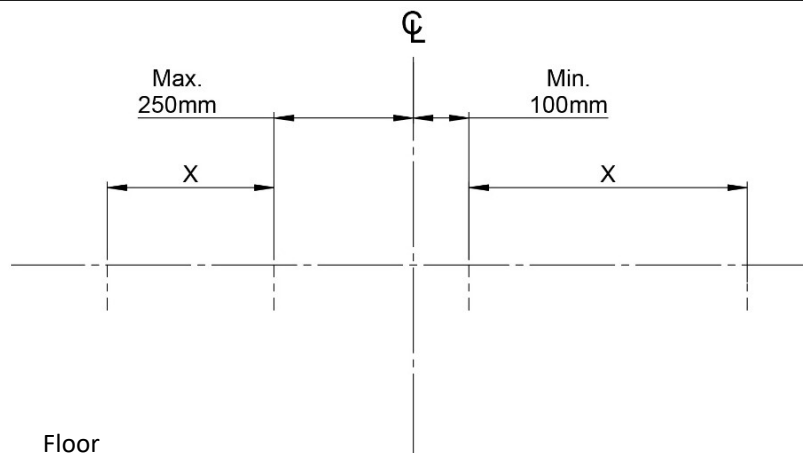

Diagram 3

Next mark the position of the outer edges of the units = **X**

Note: The maximum distance of 250mm or the minimum distance of 100mm from the Centre Line to the inside edge of the units.

The units come in two sizes W300mm and W500mm = **X**

See Diagram 3

Installation

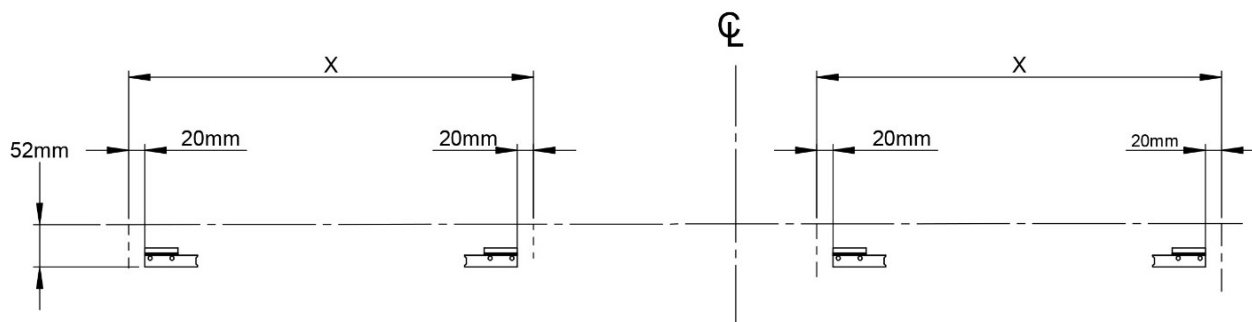

Diagram 4

Mark out the position of the wall plates (supplied as pairs) using the dimensions provided above.

Once marked, drill the fixing positions. Depending on the wall medium, it may be necessary to plug the drilled holes. See **'Important Note'** below.

Next screw and secure the wall plates to the wall using suitable screws. See **'Important Note'** below.

See **Diagram 4**

IMPORTANT NOTE:

Wall fixings (i.e. screws/wall plugs etc.) are not supplied as these are crucially dependent upon the type of wall and surface the surround is going to be fixed too. The installer is therefore responsible for ensuring that suitable fittings are used according to the particular model to be installed as well as individual fitting situations and environments. All mechanical fixings, for holding the product in position, must be secured to a solid wall or structure.

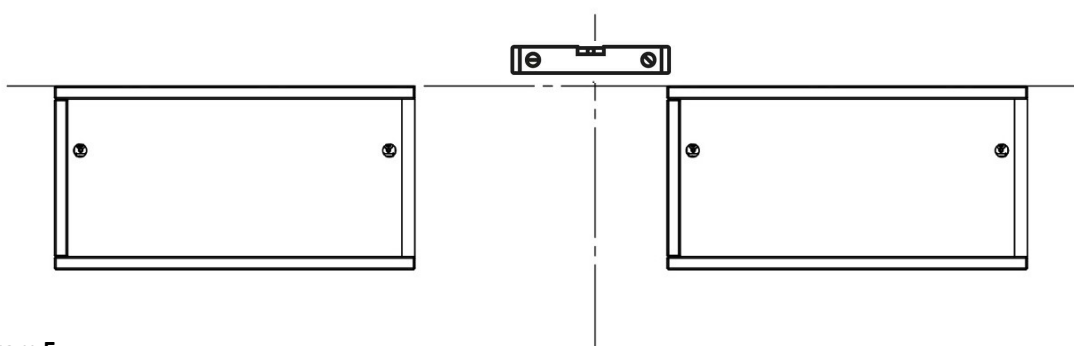

Diagram 5

Hang the units, making sure the hanging brackets on the rear of the units, engage with the wall plates on the wall.

See **Diagram 5**

Installation

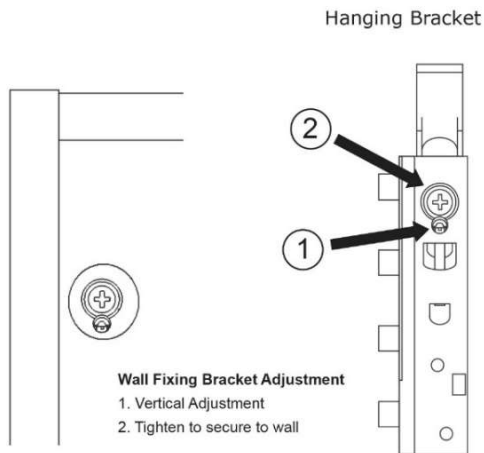

Diagram 6

Adjust the units so they sit level with each other, using a Pozi screw driver. **(1)**

Finally fix the units in position by tightening screws, using a Pozi screw driver. **(2)**

See Diagram 6

Note: Once fully adjusted & tightened fit the supplied cover caps into holes on back panel.

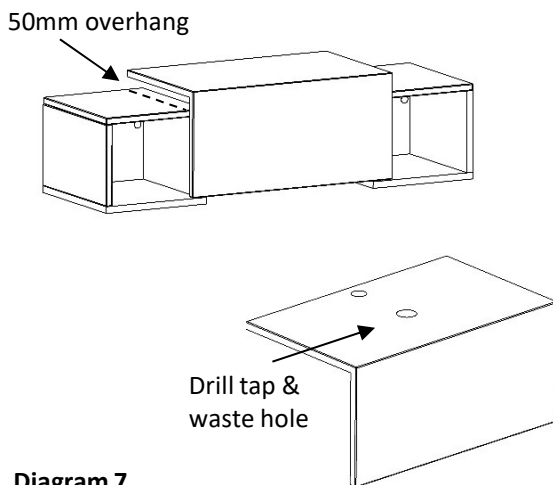

Diagram 7

Locate the top and lay it on the Units checking there is a minimum of 50mm overhang onto the units.

Once checked, place the basin on the top and work out the waste and tap pipework layout, marking it up ready to cut.

Remove the top and cut the required holes.

Note: Normal woodworking tools can be used to machine holes in the top.

See Diagram 7

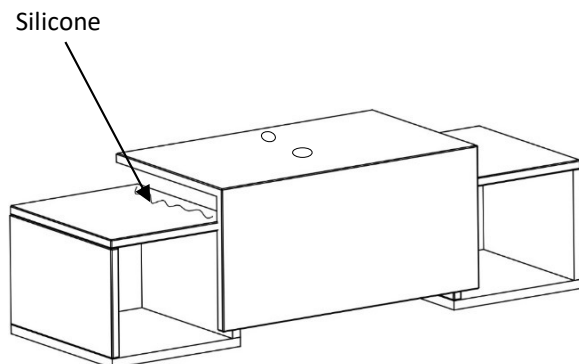

Diagram 8

Tip: Apply masking tape along the top of units, to the outside edges of where the top will be positioned. Remove immediately once the top is fitted, this will remove any overspill of silicone.

To secure the top to the units place bead of silicone along top edge of each cabinet and place the top into position, ensuring there is an even overlap on each unit.

See Diagram 8

Note: Ensure holes for tap and basin have been drilled before fitting Top.

Once set, proceed with fitting the taps, waste and basin as per the manufacturers instructions.



— est. 1964 —

REGISTER YOUR GUARENTEE – WWW.ATLANTABATHROOMS.COM

Customer Services

Tel: 0191 428 0444

Fax: 0191 489 0620